

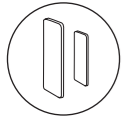

Akıllı Kapı/Pencere Sensörü



Kolay Kurulum Klavuzu



Çift Taraflı Bant

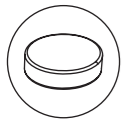

CR2 PII

1 Uygulamayı İndirin



mydlink olarak arayın ve uygulamayı indirin.

Not: Bu ürün, 'mydlink Home', 'mydlink Lite' vb. mydlink uygulamalarıyla uyumlu değildir.

2 Giriş Yapın



mydlink hesabınıza **giriş yapın** veya **kayıt olun**. mydlink Lite kullanıcıları aynı hesapla giriş yapabilirler.

3 Hub'in ayarlarını yapın

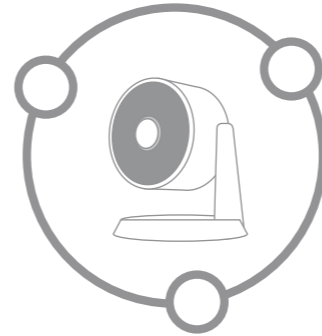

Smart Hub için verilen talimatları izleyin ve düzgün bir şekilde kurulup çalıştığından emin olun. Cihazınızı yakındaki Smart Hub ile eşleştirin.

mydlink Smart DIY hakkında daha fazla bilgi için lütfen sitemizi ziyaret edin:
<https://dlink-me.com/supporttr/>

4 Cihaz Ekleyin

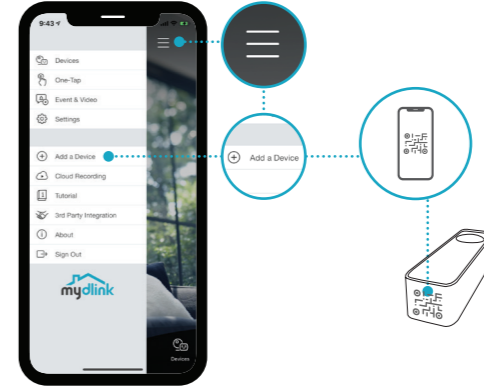

Menü düğmesine ☰ dokununuz, ardından Cihaz Ekle'ye dokununuz. Cihazdaki Kurulum Kodunu tarayın ve ardından uygulama yönergelerini takip edin.

5 Montaj



Ana Sensör Ünitesi ve Manyetik Tetikleyiciye yapıştırılmış çift taraflı bant parçalarının arkasındaki etiketleri soyun.

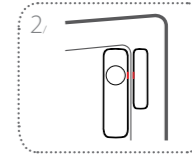

Hizalama çentiklerinin hizalı olduğundan ve iki ünitenin birbirinden en fazla 20 mm uzaklıkta olduğundan emin olun.

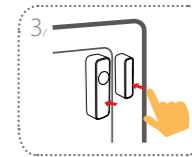

Üniteleri monte etmek istediğiniz yüzeylere sıkıca bastırarak yapışık kalmalarını sağlayın. Nemli alanlardan kaçınarak temiz ve pürüzsüz bir yüzeye monte edin.



Precautions

Caution:

Make sure that the sensor is not directly facing the sun or a source of heat.

Proper Placement:

Place the sensor at least 2.5 m or higher from the ground. The maximum distance of the motion detection is 5 m.

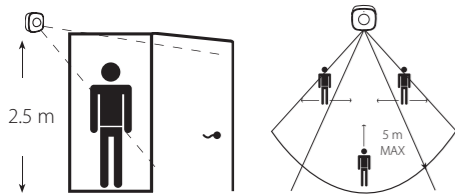

Improper Placement:

Do not place the sensor directly on top of a surface or in a spot where there is something directly below it, obstructing its view.

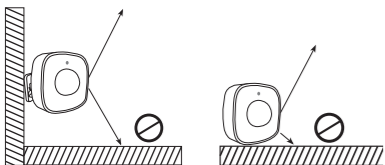

Device Information

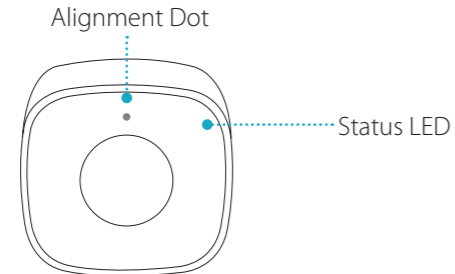

LED Behavior

- Waiting to pair
- Successfully reset
- Pairing complete
- Power saving mode



Device Information

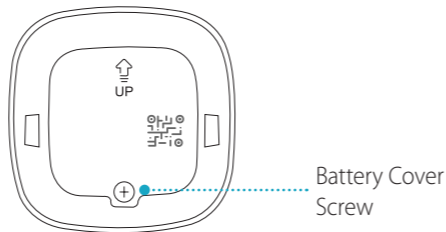

Battery Cover Removed

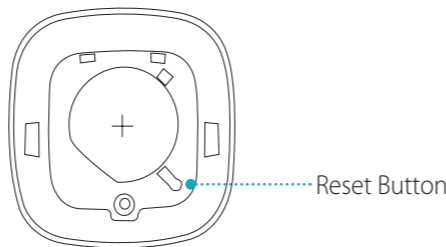

FAQ

What do I do if my device is not working properly?

Reset the device and reinstall it. To reset your device, press and hold the **Reset** button until the LED blinks red.

During installation, ensure that:

- you have an Internet connection on your router
- your router's Wi-Fi is on
- your mobile device is connected to your home network
- your mydlink Smart DIY hub* is connected to the Internet

Why does my sensor not trigger anything?

Avoid placing your sensor where it directly faces a source of heat or light as this can obscure the sensor's ability to pick up motion. Glass, plastic, or similar materials standing between the target and the sensor may not allow it to be triggered. The maximum detection distance is approximately **5 meters**.

How do I replace the battery?

Remove the mounting bracket. Use a screwdriver to unscrew the battery cover. Pull the small notch to release the battery.

* Requires a mydlink Smart DIY hub device.



Support

Having trouble installing your new product? D-Link's website contains the latest user documentation and software updates for D-Link products. Australian and New Zealand customers can contact D-Link Technical Support through our website.

Australia:

Tel: 1300-700-100
24/7 Technical Support
Web: <http://www.dlink.com.au>
E-mail: support@dlink.com.au

New Zealand:

Tel: 0800-900-900
24/7 Technical Support
Web: <http://www.dlink.co.nz>
E-mail: support@dlink.co.nz

Version 1.00 (AU)_70x110
2019/09/11

Copyright ©2019 All rights reserved. D-Link and the D-Link logo are registered trademarks of D-Link Corporation or its subsidiaries. Product specifications, size and shape are subject to change without notice, and actual product appearance may differ from that depicted on the packaging. Visit dlink.com for more details.



DCH-B122
Smart Motion Sensor

Quick Installation Guide

